

Among the Taylor Papers in the Manuscript Department of the Historical Society of Pennsylvania, are found (with a great number of others) four great surveys of lands in Lancaster County, which may well challenge our interest and which are of great value to anyone desiring, or required, to trace to the beginning, the title to lands in the central part of our county. A brief consideration of them, together with maps which are to be provided, will be of value to our membership and to the citizens of our county generally.

1. THE JOHN ESTAUGH AND COMPANY TRACT

The earliest is the Estaugh tract, the survey of which was begun October 26, 1716, and completed May 16, 1717. It is No. 2480 of the Taylor Papers (surveys). And closely related to it are Nos. 2484 and 2486 and 2488.

The surveys show the subdivisions of the tract; and this is especially true of Nos. 2480 and 2488. A map of the same before subdivision, when the tract consisted of three great divisions, may be seen in Appendix I—X of the Third Series of the Pennsylvania Archives, a volume of maps. The tract is there set out as containing 7283 acres. Conestoga Creek flows through and across the northern part of it and Mill Creek across the southern part. It is roughly five miles in length from north to south and about three miles in width from east to west, measured by the greatest dimensions; but as it contains some projecting points and angles it does not contain 15 square miles but only about 11 and 4-10 square miles. It adjoins, on the south, the original tract of 6400 acres taken up by Mennonites (the northern farm of which was that of John Bundely), Eliz. Whartenby on the east (that is the Ferree tracts), vacant land on the north, and William Hughs and Hans Graff on the west.

It was roughly bounded by the line from Mylin's Corner to Lampeter on the south; the line from Lampeter to Smoketown and Witmer in the east; Witmer and Binkley's or Eden on the North and Eden, Lancaster and the northern end of Willow Street on the west.

It is part of 12871 acres ordered by warrant granted October 18, 1716 to be laid out for Estaugh (Vol. 19, Second Ser. Pa. Arch p. 608 and 9.)

The subdivisions show tracts surveyed for Jacob Moyer, Hance Henry Moyer and Henry Bare of 1060 acres; Jacob Groff and John Groff each 212 acres; Hans Groff 200 acres; Henry Groff 424 acres; Peter Yordy, Darrick Janson and others, large tracts; Nathan Miller 429 acres; John Musgrove 800 acres; John Hendricks, Andrew Seldomrich, large tracts; Jac. Landis and John Landis 424 acres; Jac. Hendricks 424 acres; Benj. Witmer 250 acres; Hans Snyder a large tract; Isaac Hendricks 250 acres and John Evans a large tract; and smaller tracts to several others. For more particular information as to the location of the last named farms in the original tract consult the map and key to the same.

2. LAND ON PEQUEA BELOW BEAVER CREEK

The next tract is a large one on Pequea, below Beaver Creek. It is marked as having been surveyed October 27, 1728. This however may be the date of the survey of only part of it. It is No. 2552 in the archives before mentioned. It includes the land between West Willow, Morton's Shop (about two miles south of New Danville) the eastern end of Conestoga Center, Marticville, Martic Forge, east to Baumgardner's (late Hess's) Mill, Byerland Mennonite Meeting House, near Herrville, Baumgardner's Station and West Willow. It is mainly between the lower Pequea, north of Martic Forge and Morton's Run dividing Conestoga and Pequea Townships.

This tract is roughly about 1200 perches or say four miles in length from east to west and 800 perches or two and a half miles in width from north to south; and it is bounded by the Amos Strettle Tract on the east and John Jacob Myers and others on the north.

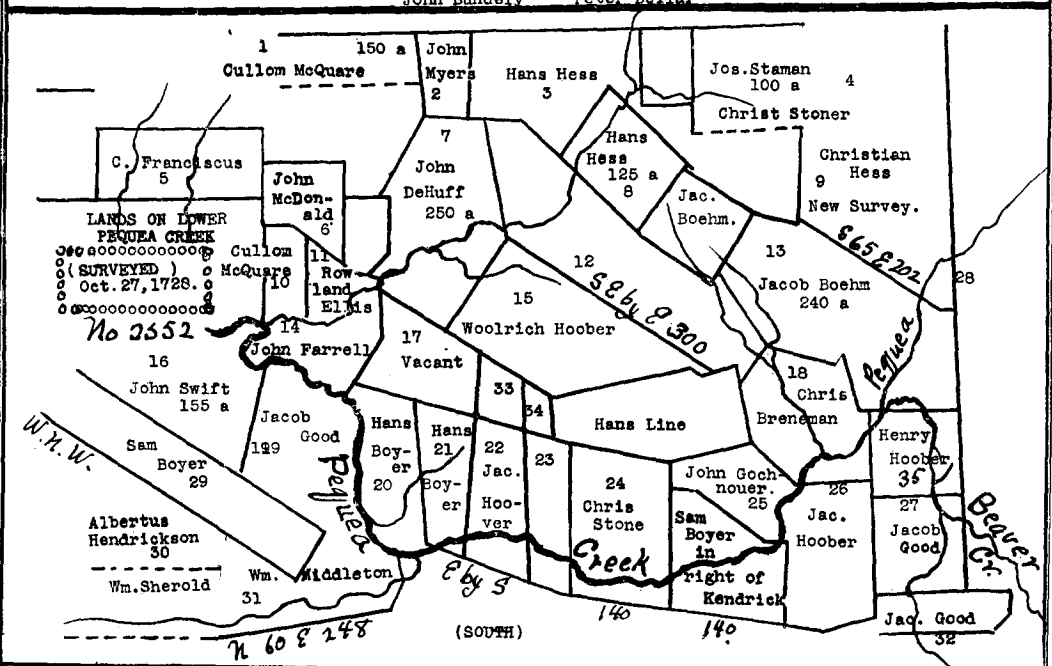
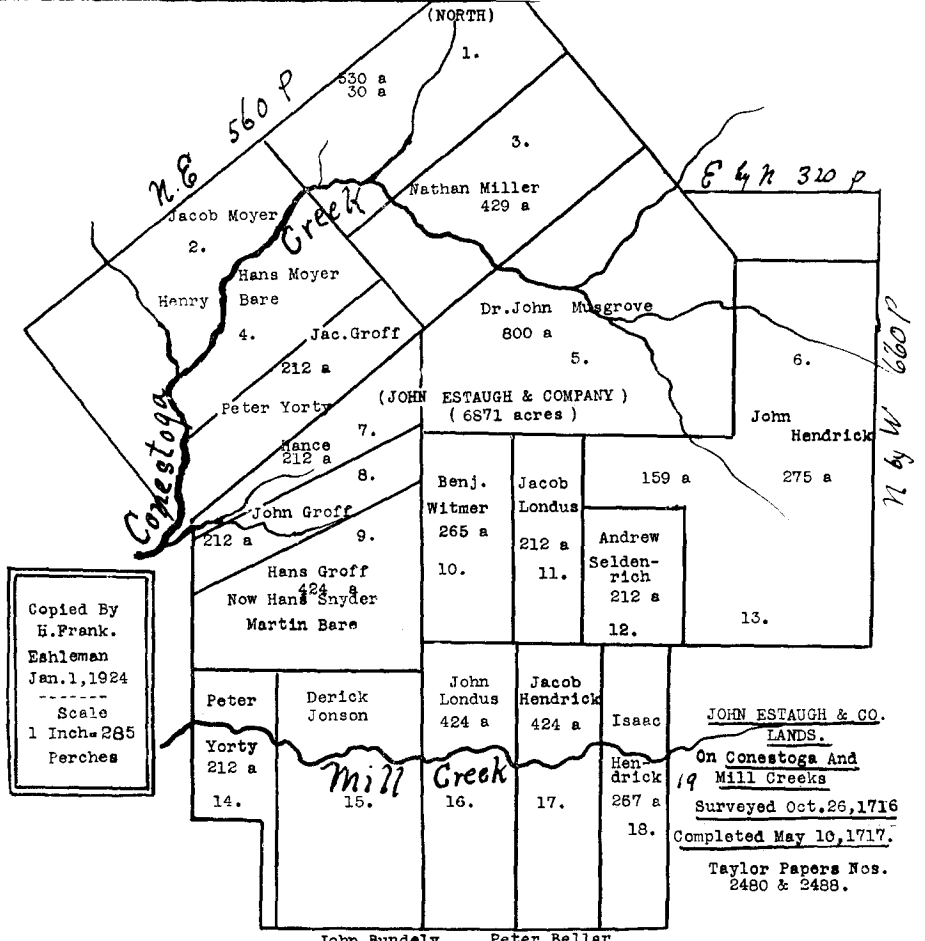

Near the northwestern corner is one of the Cullon McQuire Tracts (near Morton's Shop) and reading the farms from that point along an irregular tier to the northeastern corner near Baumgardner's Station there are John Jacob Myers, Hans Hess, Jas. Stoner and other lands. Also in the northwestern corner somewhat loosely attached are the Christian Franciscus tract, John McDonald and other small tracts. Passing eastward by a second tier of farms we have the tracts of John DeHuff, a vacant tract, Henry Hess, Jacob Boehm, Christian Hess, now Snavelly, Christian Stoner to the northeastern corner near West Willow and Baumgardner's Station. South of this tier reading from the west are the small farms of Collum McQuire, Rowland Ellis, and the large ones of Ulrich Hoover, Jacob Boehm, Hans Line, Christian Breneman and J. Hoover. Some of these tracts lie on Morton's Run and some between the run and the Pequea.

The farms of the next tier lie on the Pequea proper, either on the north side or on both sides. Beginning at the western end they are tracts of John Farrell, Hans Boyer, Jac. Hoover, Christ Stoner, John Gochenour, Christ Breneman and Henry Hoover.

The tracts south of the Pequea, beginning at the southwest corner of the tract are those of John Swift, Jac. Good, Samuel Boyer, Albertus Hendricks, Wm. Sherrell, William Middleton for Robt. Middleton (all in the neighborhood of Marticville and Martic Forge); also of John Huber, Henry Huber and Jacob Good, the last three named forming the southeast corner of the tract at the point where the Big Beaver enters the Pequea. Reference to the map and the use of the key in connection with the reading of the map, will enable one to locate any of the subdivisions or farms; and to determine who at present reside on these tracts.

3. THE AMOS STRETTLE TRACT

It is most likely that the Amos Strettle tract or survey is the next one in order of age, through the survey is not dated. This lies south of the original Swiss Mennonite Tract of 1710, and is on Mill Creek, the Pequea traversing only the northwest corner of it. The Mennonite Tract lies in the heart of Pequea Valley, the creek passing diagonally through the center of it. The Estaugh Tract lies north of the Mennonite Tract as we have seen on Mill Creek and Conestoga River. The Strettle tract contained 3380 acres and is survey, or Taylor Paper No. 2491. It is two miles wide from north to south and two and seven-eighth miles long, from east to west. With the exception of a slight irregularity on the eastern end it is a parallelogram. The Little Beaver Creek flows from the southeastern corner to the western edge where it enters the Pequea about 150 perches from the northwestern corner. This locates the tract. Big Beaver flows through the extreme southwestern corner of it. The direction of the northern and southern boundary lines are west by south and north by east. It was so surveyed in order that the Little Beaver should pass through it in the manner described.

From east to west it is surveyed into the following farms, in two tiers, the northern tier of farms being in length from north to south about half a mile and the southern tier being about one and one-half miles in length from north to south. The northern tier beginning at the eastern end are those of Jacob Hendrick, Woolrich Brackbill, and Henry Shank (these are about a mile long from north to south); then those of Jacob Miller, Martin Miller, Haldy Miller, John Breneman and John Herr, are all half mile deep.

The southern tier at the east begins with two small farms one north of the other Jacob Mylin (?) and John Eckman; and then following these several farms a mile and a half deep ranged from east to west as follows: Jac. Hostetter, Woolrich Brackbill, Alex Haldy (?), Peter Sikes, Henry Harnis, (Harnish), Mart Baer, Henry Carpenter, John Funk and Christian Musser. The last two are only about a mile deep, as there is a vacant

AMOS STRETTELE
SURVEY
ON
BEAVER CREEK
3380 e
Taylor Paper
2491

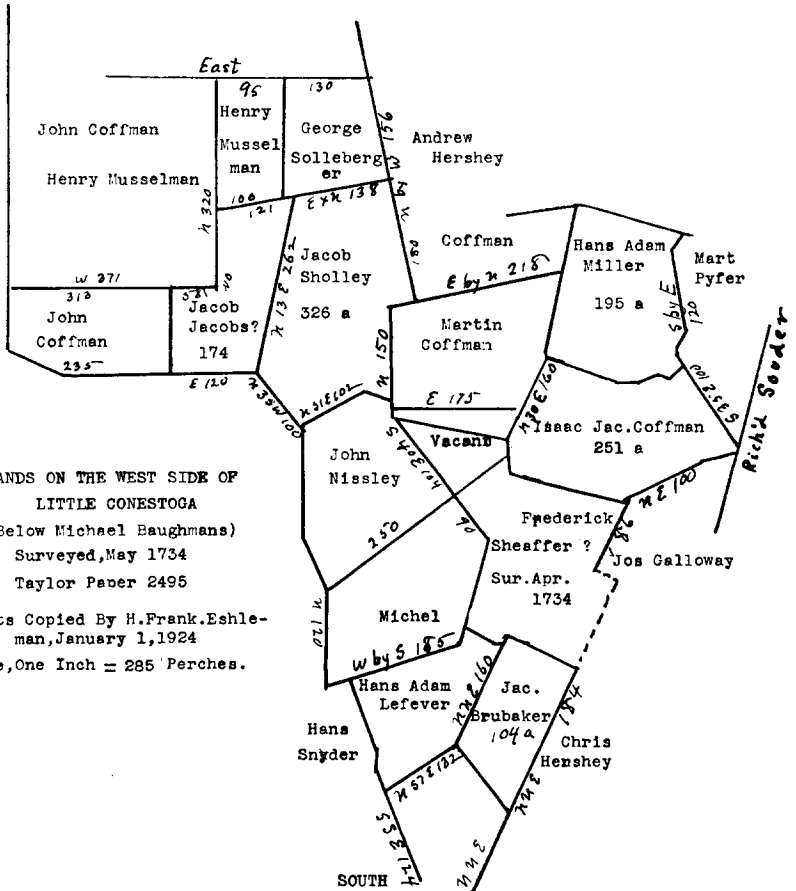
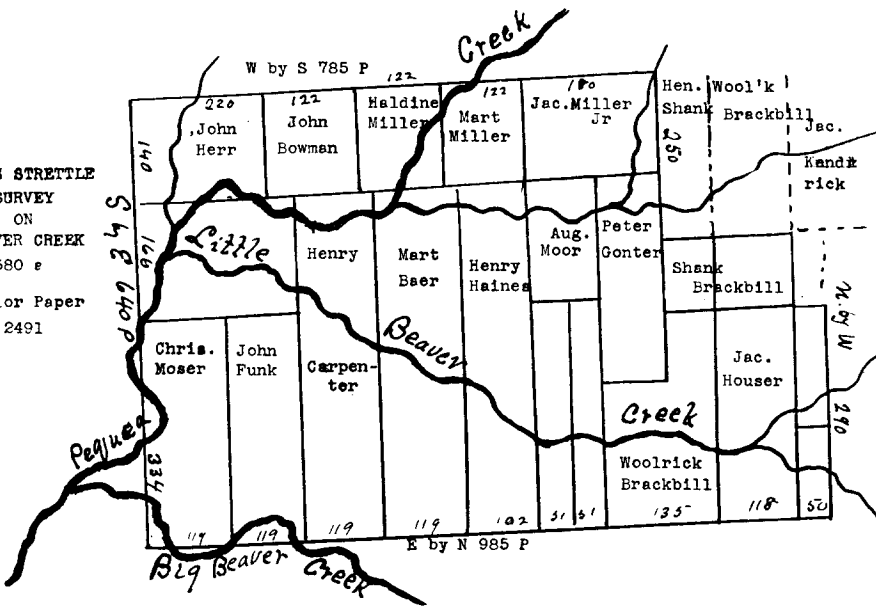

LANDS ON THE WEST SIDE OF
LITTLE CONESTOGA
(Below Michael Baughmans)
Surveyed, May 1734
Taylor Paper 2495

Drafts Copied By H. Frank. Eshle-
man, January 1, 1924
Scale, One Inch = 285 Perches.

tract where the Little Beaver enters the Pequea, between the northern and southern tier. Consult the accompanying map for more definite information.

4. TRACT IN WEST SIDE OF LITTLE CONESTOGA

The next tract in order of time, apparently is the tract on the Little Conestoga "below Michael Baughman's". It is Taylor Paper No. 2495. It is not dated on its face.

The tract was surveyed into the following farms reading from the northwest to the south or southeast; the tract being roughly triangular somewhat like the shape of Africa. The farms are those of John Coffman 200 acres, Henry Musselman 103 acres, (2 farms), John Coffman, Geo. Sollenberg 138 acres, Jacob Solley 326 acres, Mart Coffman 230 acres; John and Hans Nissley, Henry Adam Miller, 195 acres; Isaac Jacob Kauffman 251 acres, Fred Sheppard,———Mitchel 249 acres, Jacob Burkholder 104 acres, and Henry Adam Liphart or Lefever (?).

The tract is partly bounded on the north by Martin Pyfer and Andrew Hershey; on the east by Mart Pyfer, Rudy Sowders, Jas. Galloday and Christ. Hershey; and on the west by owners not named, except Hans Snyder near the southern apex. It is a tract, no doubt, in the northern section of Manor Township. See the map for further particulars.

These data are submitted not for their entertaining quality; but as needed help to trace present land titles and the lines or courses and distances, to their origin. All of this matter will be of help to title searchers and others, interested in ascertaining the true original boundaries of the farms and tracts included in the surveys.

H. FRANK ESHLEMAN.